

※NOTES※

MECHANICAL

- ① HOUSING : THERMOPLASTIC-NYLON 66, UL94V-0  
SELECTIVE COLOR
- ② CONTACT : PHOSPHOR BRONZE

SPECIFICATION

- ① VOLTAGE RATING : 100V AC/DC
- ② CURRENT RATING : 2AMP AC/DC
- ③ WITHSTANDING VOLTAGE : 800V AC FOR 1 MINUTE
- ④ TEMPERATURE RANGE : -25°C ~ +85°C
- ⑤ INSULATION RESISTANCE : 1,000MΩ MIN.
- ⑥ CONTACT RESISTANCE : 10mΩ MAX.
- ⑦ WIRE RANGE : AWG#22~#28

PRODUCT ORDER OPTION

PWB05-5 \* JP0 \*\* MH

CKT NO.

HOUSING COLOR  
1~BLACK  
2~WHITE

CKT	DIM. A	DIM. B	DIM. C
02	2.00	5.80	4.60
03	4.00	7.80	6.60
04	6.00	9.80	8.60
05	8.00	11.80	10.60
06	10.00	13.80	12.60
07	12.00	15.80	14.60
08	14.00	17.80	16.60
09	16.00	19.80	18.60
10	18.00	21.80	20.60
11	20.00	23.80	22.60
12	22.00	25.80	24.60
13	24.00	27.80	26.60
14	26.00	29.80	28.60
15	28.00	31.80	30.60
16	30.00	33.80	32.60
17	32.00	35.80	34.60
18	34.00	37.80	36.60
19	36.00	39.80	38.60
20	38.00	41.80	40.60

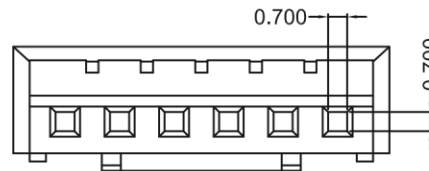
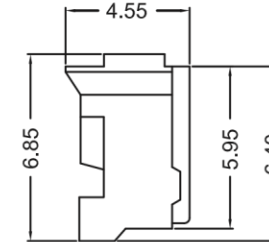
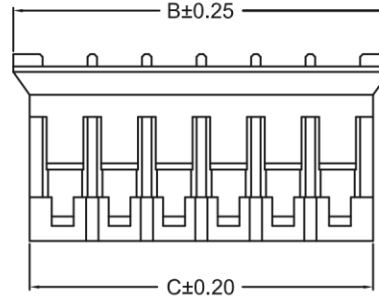
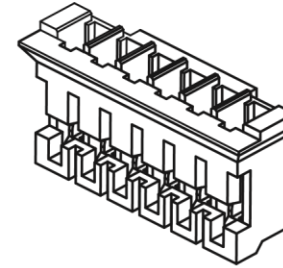
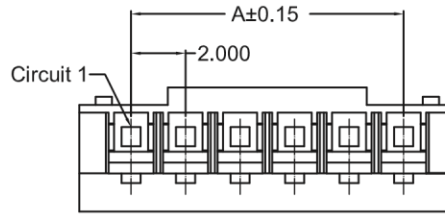

QUALITY CONTROLING 品質管理 THE SYMBOL AS ★	<b>METRIC</b>		<b>Han Electronic</b>	
	DRAWER	Y. TOMITA		
RoHS COMPLIANT HFP HIGHER PERFORMANCE	APPROVER	P. TURNEAU		TITLE  PITCH 2.00mm WIRE TO BOARD CONNECTOR PLUG, HOUSING
	DIMENSIONS ARE IN MILLIMETERS TOLERANCES			
DO NOT SCALE DRAWINGS 縮尺不可 THIRD ANGLE PROJECTION	X. ----- X.X ±0.38 X.XX ±0.25 X.XXX ±0.10 ANGLES ±2°		PRODUCT NUMBER PWB05-5*JP0**MH	
	SIZE	REV.	SCALE	SHEET 1 OF 2
A4		2.5 : 1		

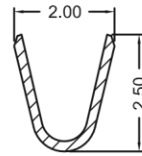
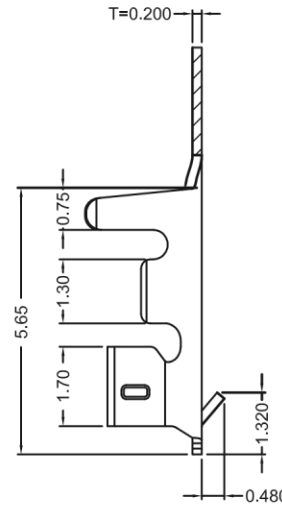
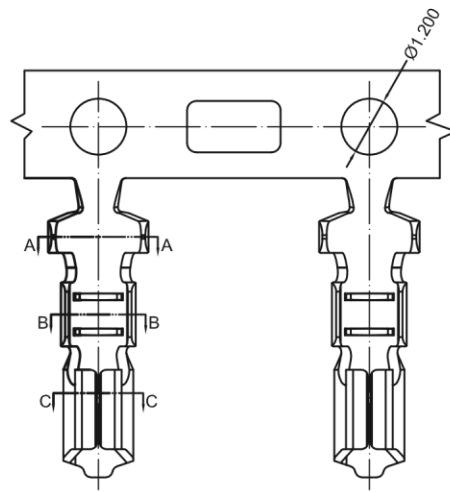

SECTION: A-A  
SCALE: 1:1

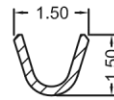

SECTION: B-B  
SCALE: 1:1

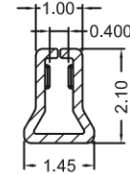

SECTION: C-C  
SCALE: 1:1

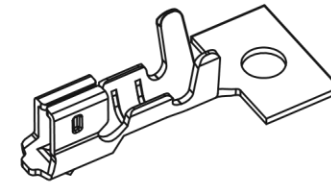

QUALITY CONTROLING DEPENDANT ALL PRODUCT THE SYMBOL AS	<b>METRIC</b>		<b>Han Electronic</b>	
	DRAWER	Y. TOMITA		
	APPROVER	P. TURNEAU	TITLE  PITCH 2,00mm WIRE TO BOARD CONNECTOR PLUG, TERMINAL	
	DIMENSIONS ARE IN MILLIMETERS TOLERANCES  X. ----- X.X ±0,38 X.XX ±0,25 X.XXX ±0,10 ANGLES ±2°			
RoHS COMPLIANT HF LF	DO NOT SCALE DRAWINGS  		PRODUCT NUMBER <b>PWB05-5×JP0××MH</b>	
SIZE <b>A4</b>	REV.	SCALE <b>2,5 : 1</b>	SHEET <b>2</b> OF <b>2</b>	